

LIGHTHOUSE STUDIOS

SUITE 303 1235 - 26 AVENUE SE
 CALGARY, AB
 T2G 1R7
 TEL. 217-2363
 FAX 234-8583

GENERAL NOTES

1. THE CONTRACTOR IS TO VERIFY ALL DIMENSIONS. ANY DISCREPANCIES BETWEEN THE DRAWINGS AND EXISTING CONDITIONS MUST BE REFERRED TO THE DESIGNER FOR ADJUSTMENT BEFORE ANY WORK AFFECTED IS BEGUN.
2. THE CONTRACTOR IS TO COMPLY WITH ALL APPLICABLE BUILDING CODES, ORDINANCES AND REGULATIONS
3. DO NOT SCALE THESE DRAWINGS
4. ALL DRAWINGS ARE COPYRIGHT MATERIAL AND MAY NOT BE REPRODUCED WITHOUT PERMISSION FROM LIGHTHOUSE STUDIOS INC.

ISSUED

- 05/02/18 FOR DEVELOPMENT PERMIT
 07/04/18 FOR DP REVISIONS
 08/10/18 FOR BUILDING PERMIT

REVISIONS

PROJECT

820 MADISON AVENUE SW
 CALGARY, ALBERTA

DRAWING TITLE

LOFT FLOOR PLAN

PROJECT # : 18-05

DATE : 08/10/18

DRAWN BY : JJA

SCALE : AS NOTED

SHEET : A5 OF 12

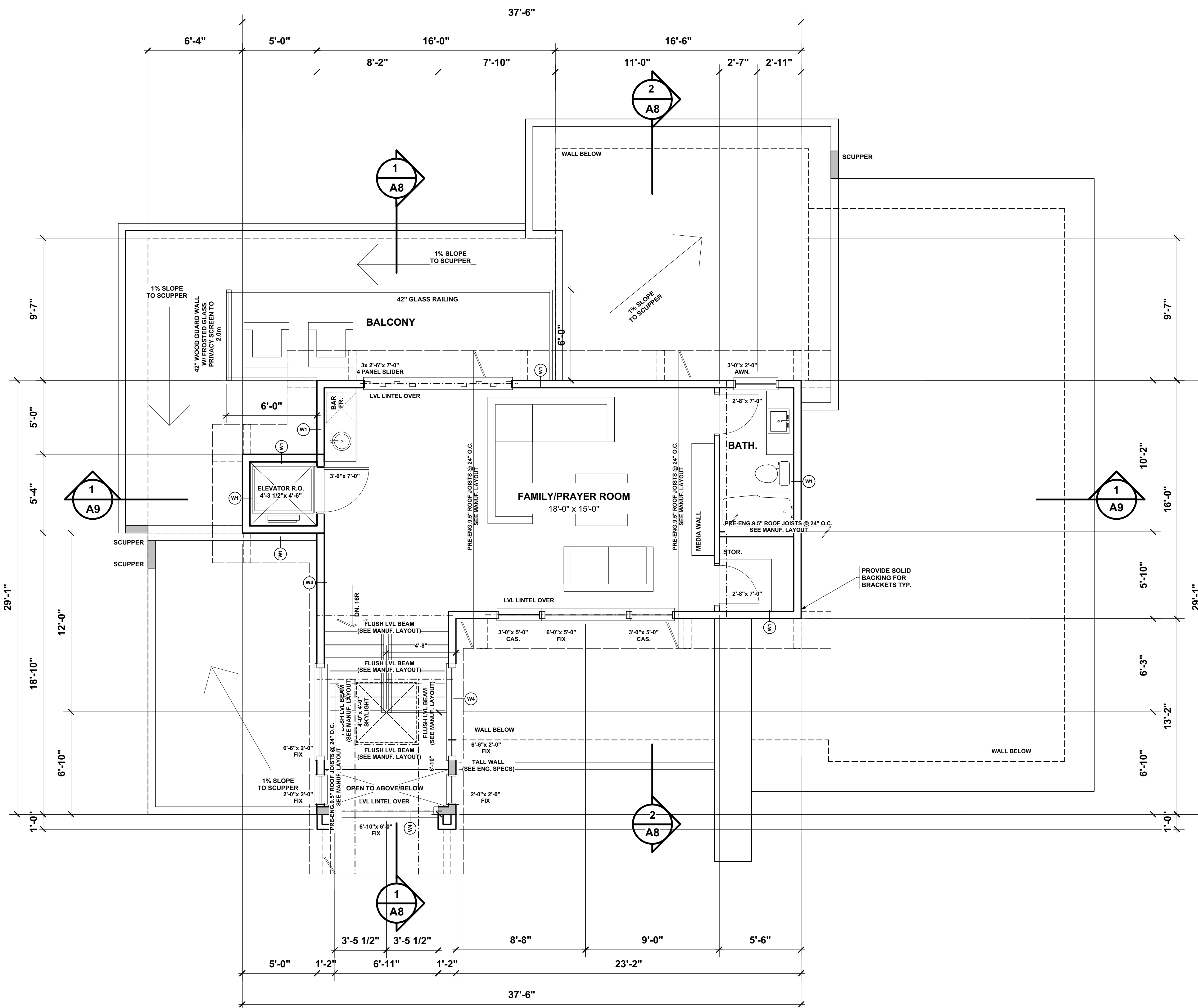

NOTE:
 ALL LINTELS TO BE 2 PLY
 2x10 #2 SPF UNLESS
 OTHERWISE NOTED

NOTE:
 DIMENSIONS ARE TO FACE
 OF SHEATHING ON EXT. WALLS
 FACE OF STUD ON INT. WALLS
 AND TO FACE OF CONC.
 ON BASEMENT WALLS

ALL DOOR / WINDOW DIMENSIONS
 ARE TO CENTER OF OPENING.
 ROUGH OPENINGS TO BE PROVIDED
 BY MANUFACTURER.

1 LOFT FLOOR PLAN
 A5 SCALE 1/4" = 1'-0" 615 sq.ft.

