

LIGHTHOUSE STUDIOS

SUITE 303 1235 - 26 AVENUE SE
CALGARY, AB
T2G 1R7
TEL. 217-2363
FAX 234-8583

GENERAL NOTES

1. THE CONTRACTOR IS TO VERIFY ALL DIMENSIONS. ANY DISCREPANCIES BETWEEN THE DRAWINGS AND EXISTING CONDITIONS MUST BE REFERRED TO THE DESIGNER FOR ADJUSTMENT BEFORE ANY WORK AFFECTED IS BEGUN.
2. THE CONTRACTOR IS TO COMPLY WITH ALL APPLICABLE BUILDING CODES, ORDINANCES AND REGULATIONS
3. DO NOT SCALE THESE DRAWINGS
4. ALL DRAWINGS ARE COPYRIGHT MATERIAL AND MAY NOT BE REPRODUCED WITHOUT PERMISSION FROM LIGHTHOUSE STUDIOS INC.

ISSUED

- 07/12/17 FOR DEVELOPMENT PERMIT
10/03/17 FOR DP REVISIONS
11/27/17 FOR BUILDING PERMIT

REVISIONS



PROJECT

3924 CRESTVIEW RD SW
CALGARY, ALBERTA

DRAWING TITLE

LOFT FLOOR PLAN

PROJECT # : 17-04

DATE : 11/27/17

DRAWN BY : JJA

SCALE : AS NOTED

SHEET : A5 OF 12

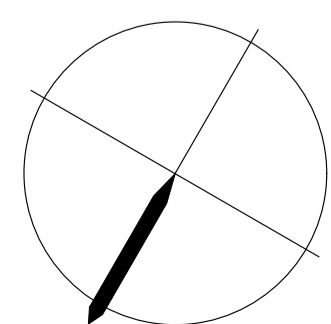
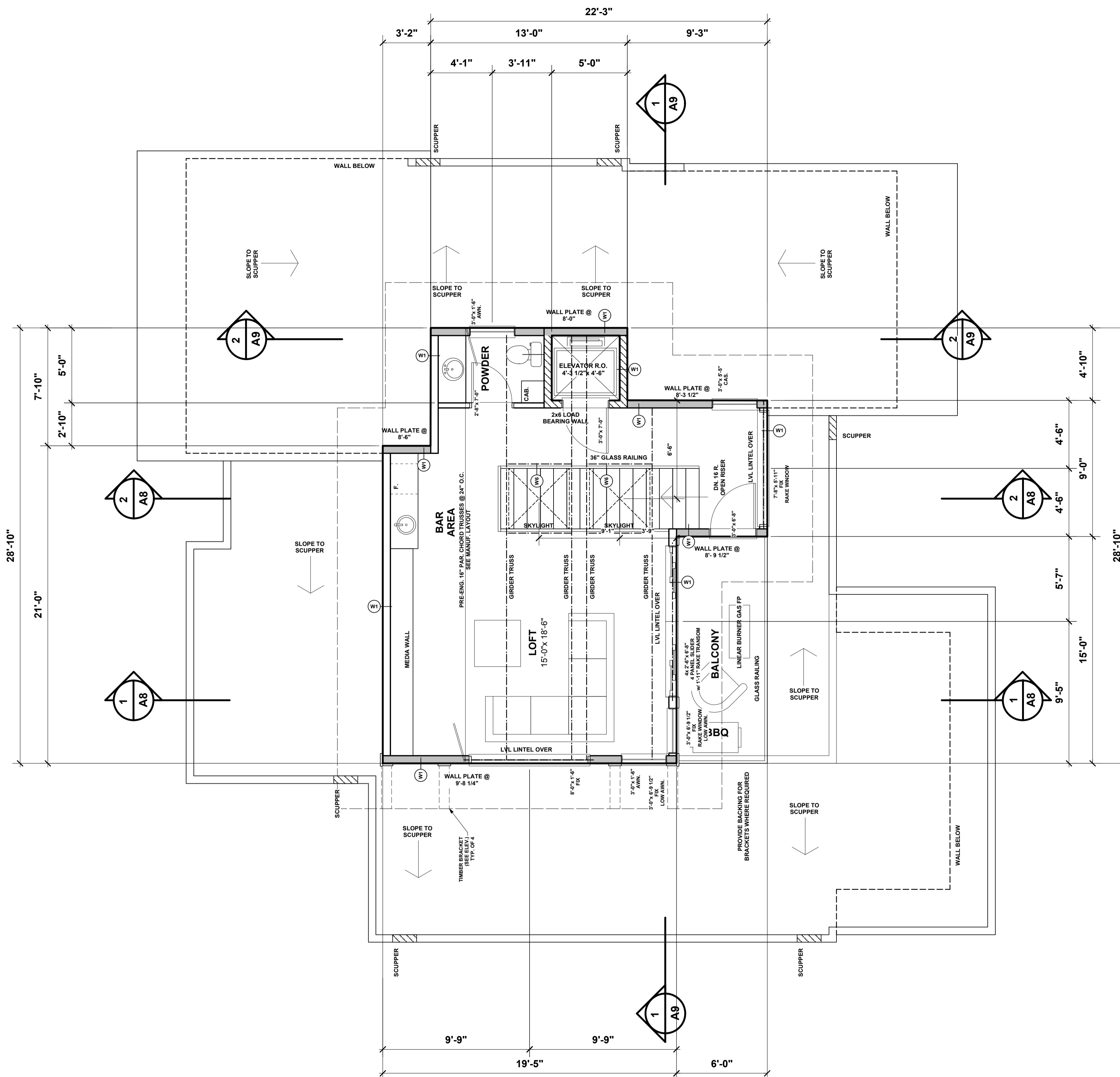

1 LOFT FLOOR PLAN
A5 SCALE 1/4" = 1'-0" 571 sq.ft.